

SHOWCASE HOME | CAROLINE

KOLTER HOMES®

Street Address: 205 SE Via Sangro, Port St Lucie, FL 34952

A/C Sq. Ft.: 1788

Bedrooms: 3

Bathrooms: 2

Move-In Date: April - May - June



ELEVATION: C

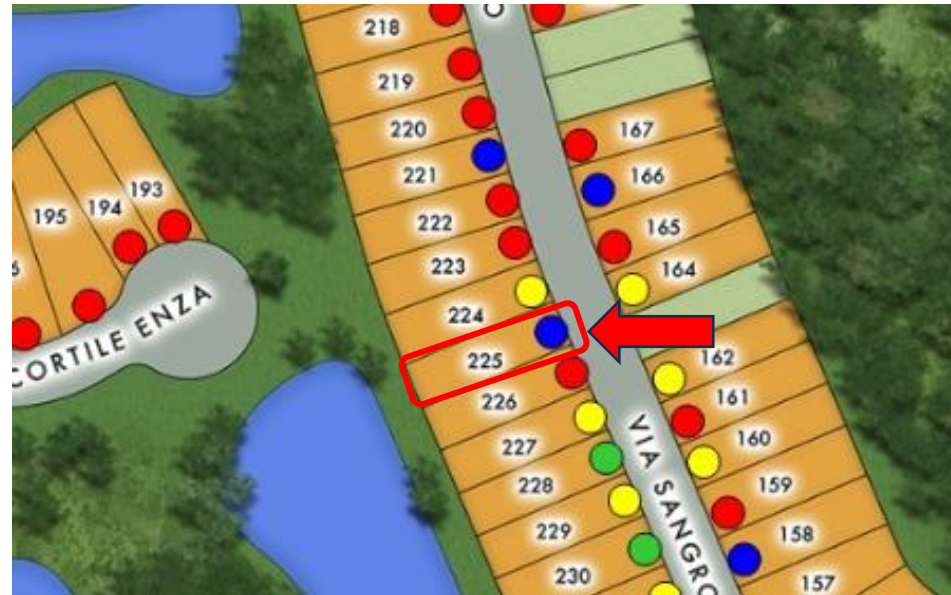

HOMESITE: 225

Exterior Color Package: Color Scheme C-1 – Front Door: SW7047 Seaworthy, Garage Door: SW7005 Pure White, Roof: BelAir Light Gray Range, Shutter: Bronze, Trim: SW7005 Pure White Stucco, Siding, Batten and Shake: SW7015 Repose Gray

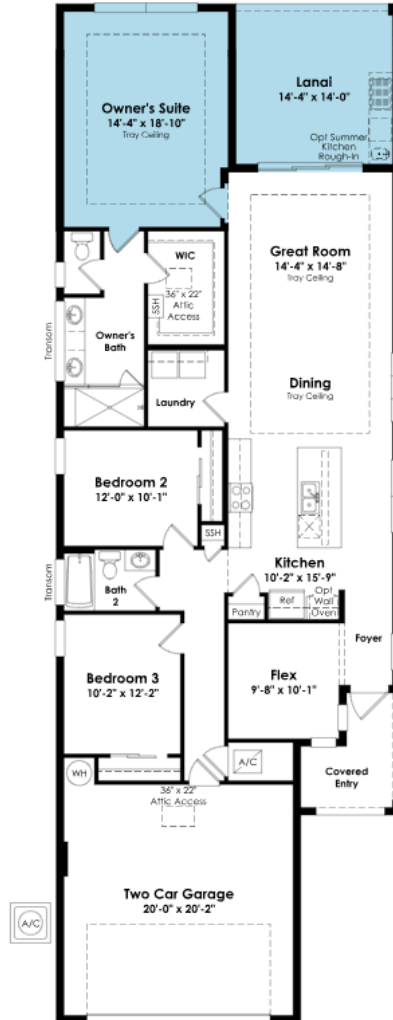

SHOWCASE HOME FLOORPLAN

THE CAROLINE

3 Bedroom, flex, 2 Full Bath, Great Room, Covered Lanai and 2-Car Garage

Structural Changes:

- 9' Wide x 10' Tall sliding glass door
- 4' Owner Suite and Lanai Extension
- 5' Privacy wall with pre-plumb for summer kitchen

SHOWCASE HOME FEATURE HIGHLIGHTS

KITCHEN DETAILS

- Gourmet kitchen configuration including wall oven and wall microwave
- Under cabinet lighting
- 2 outlets (pendant prewire) above island
- Quartz countertops and backsplash
- Stainless Steel Single Bowl Undermount Sink

DESIGNER FEATURES

- Upgraded lighting package throughout
- Laminate wood floor in Main Living Area and Flex
- Wall Cabinets in Laundry
- Frameless shower in Brushed Nickel in Primary Bath
- Extended shower wall tile in primary bath
- Extended bath wall tile in Bath #2
- Comfort Height toilets in both baths
- Quartz countertops in both baths
- Shower Niche in Bath #2
- Gutters on all 4 sides of home

SHOWCASE HOME DESIGNER FEATURES | KITCHEN

CABINETS



**COUNTERTOP
QUARTZ**



BACKSPLASH



**MAIN
FLOORING**



Trinket Oak | 04

**CABINET
HARDWARE**



BP36873-G10

FAUCET



SINK



SHOWCASE HOME DESIGNER FEATURES | OWNERS BATH

CABINETS



COUNTERTOP QUARTZ



Statuary Glory - QTZ L3

FLOORING



WALL TILE



CABINET HARDWARE



BP36872-G10

PLUMBING



SHOWER FLOOR



SHOWCASE HOME DESIGNER FEATURES | BATH #2

CABINETS



COUNTERTOP QUARTZ



Statuary Glory - QTZ L3

FLOORING



WALL TILE



CABINET HARDWARE



BP36872-G10

PLUMBING

