

# SHOWCASE HOME | POPLAR

# CRESSWIND®

Street Address: 190 TRUMAN COURT

A/C Sq. Ft.: 2600

Bedrooms: 3

Bathrooms: 3.5



**ELEVATION: CB**

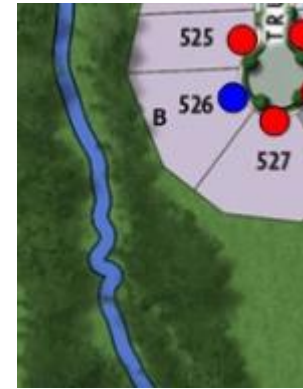

**HOMESITE: 526**

Cresswind Twin Lakes | 118 Hartwell Court, Hoschton, GA 30548



©2022. Prices, homesites, amenities, home designs, square footage and other information subject to errors, changes, omissions, deletions, availability, prior sales and withdrawal at any time without notice. Square footage numbers are approximate and may vary depending on the standard measurement used. Photos and/or drawings of homes may show upgraded landscaping and may not represent the lowest priced homes in the community. All renderings and floorplans in these materials are an artist's conceptual drawings and will vary from the actual plans and homes as built. CGC1509406

**KOLTERHOMES®**

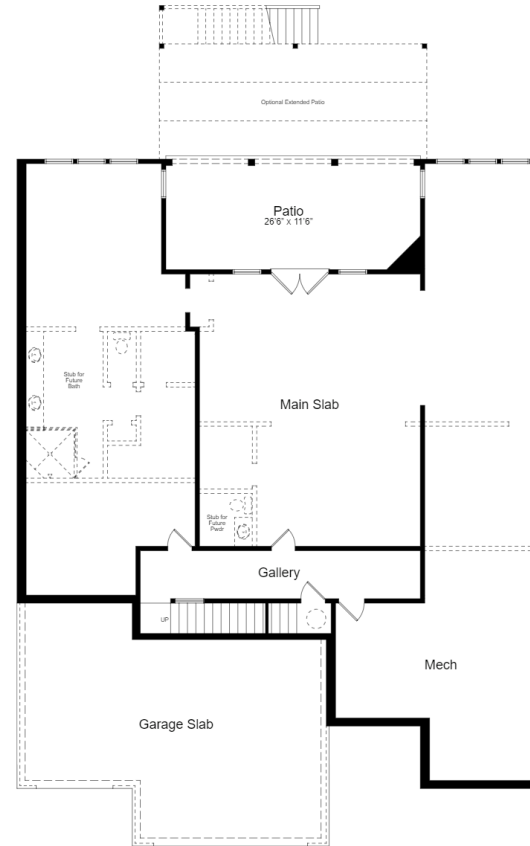
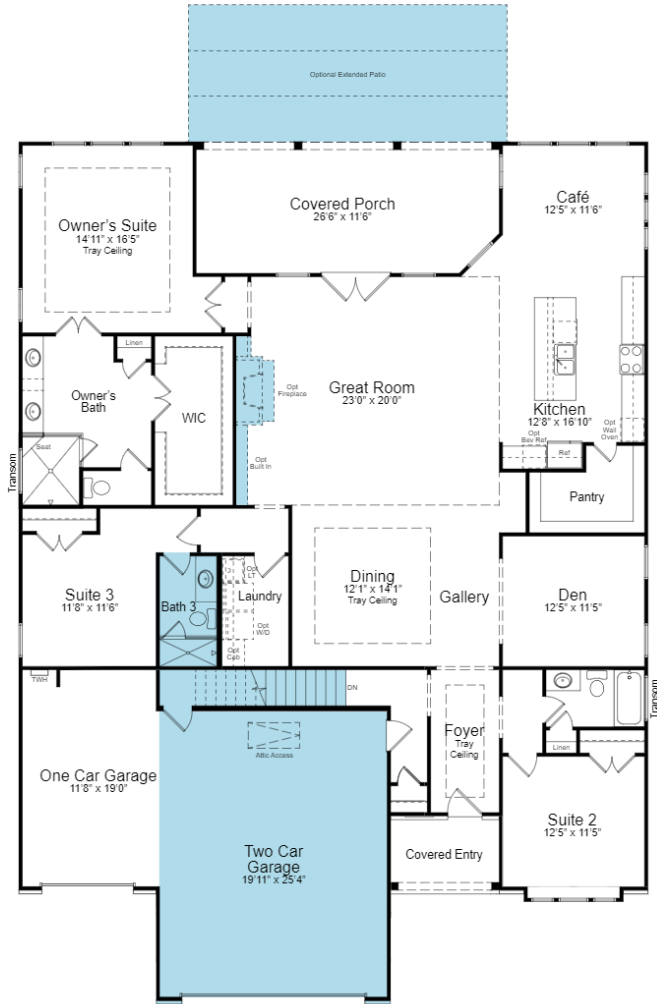

## SHOWCASE HOME FLOORPLAN

### ROSEWOOD

3 Bedroom, 3.5 Bath, Den, Great Room, Covered, Extended Deck, 2-Car Garage and Unfinished Bonus

Cresswind Twin Lakes| 118 Hartwell Court, Hoschton, GA 30548



## SHOWCASE HOME FEATURE HIGHLIGHTS

### KITCHEN DETAILS

- 30" gas 5-burner cooktop
- Cabinet crown molding
- Quartz countertops
- EVP flooring
- Under Cabinet Lighting
- Stainless Steel Single Bowl Undermount Sink

### DESIGNER FEATURES

- 4 FT. garage extension
- Frameless shower in owner's bath
- Laundry Room with wall cabinets and laundry sink
- Gourmet kitchen
- Direct vent linear fireplace
- Extended Lanai
- Unfinished Bonus Room

Cresswind Twin Lakes| 118 Hartwell Court, Hoschton, GA 30548



## SHOWCASE HOME DESIGNER FEATURES | KITCHEN

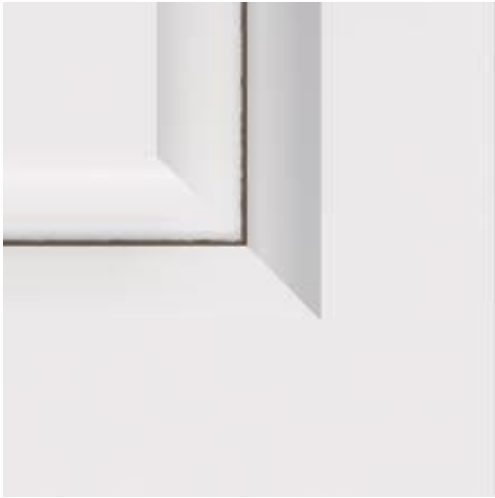

**LEVEL 4 KAYES CABINETS  
WHITE**



**MOEN ALIGN SPRING PULL DOWN  
FAUCET AND SOAP DISPENSER  
SPOT RESISTANT STAINLESS**



**LEVEL 3 QUARTZ COUNTERTOP  
LUSSO**



**MOROCCO  
ARABESQUE SILVER  
BACKSPLASH**

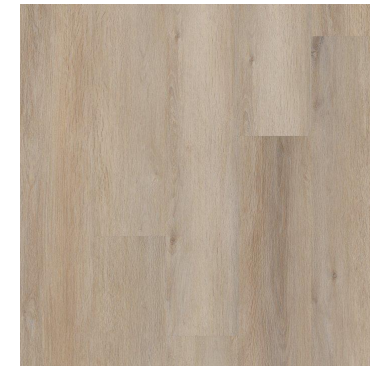

**SHAW EVP FLOORING  
REVERED / ALDERGROVE  
OAK**

Cresswind Twin Lakes | 118 Hartwell Court, Hoschton, GA 30548



## SHOWCASE HOME DESIGNER FEATURES | KITCHEN APPLIANCES

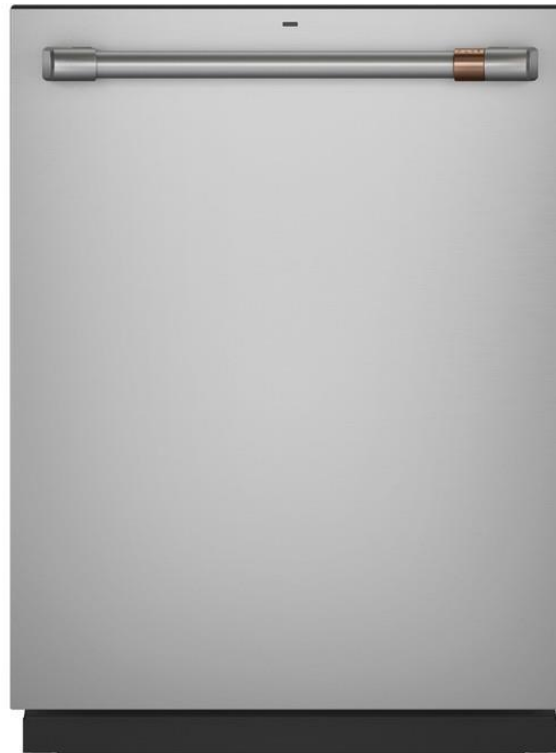

Cresswind Twin Lakes | 118 Hartwell Court, Hoschton, GA 30548





# SHOWCASE HOME DESIGNER FEATURES | OWNERS BATH

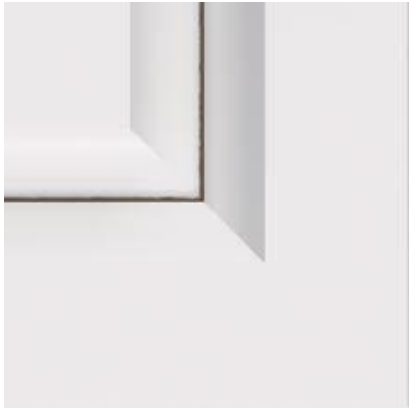

**LEVEL 4  
CABINETS –  
KAYES  
WHITE**



**MOEN VOSS  
8" SPREAD  
BRUSHED  
NICKEL**



**SILESTONE  
QUARTZ-  
ARIEL**



**SHOWER FLOOR**



**CONTESSA ORO MATTE  
SHOWER WALLS AND  
BATHROOM FLOOR**

Cresswind Twin Lakes | 118 Hartwell Court, Hoschton, GA 30548



## SHOWCASE HOME DESIGNER FEATURES | BATH 2

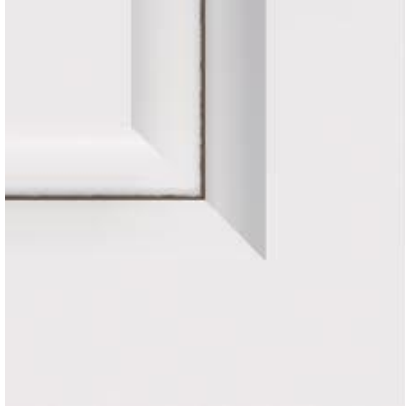

**LEVEL 4  
CABINETS  
KAYES  
WHITE**



**ARIEL  
SILESTONE  
QUARTZ**

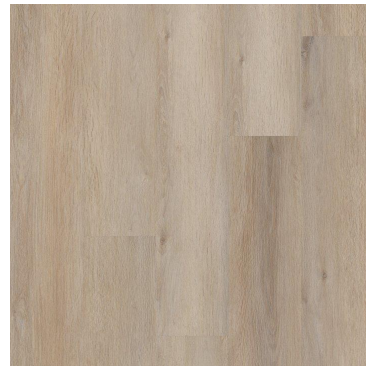

**BATHROOM FLOORS  
EVP REVERED/ALDERGROVE OAK**



**BATHROOM WALLS  
CONTESSA ORO MATTE**



**MOEN VOSS  
SINGLE LEVER  
BRUSHED  
NICKEL**

Cresswind Twin Lakes | 118 Hartwell Court, Hoschton, GA 30548



©2022. Prices, homesites, amenities, home designs, square footage and other information subject to errors, changes, omissions, deletions, availability, prior sales and withdrawal at any time without notice. Square footage numbers are approximate and may vary depending on the standard measurement used. Photos and/or drawings of homes may show upgraded landscaping and may not represent the lowest priced homes in the community. All renderings and floorplans in these materials are an artist's conceptual drawings and will vary from the actual plans and homes as built. CGC1509406

**KOLTERHOMES®**

## SHOWCASE HOME DESIGNER FEATURES | BATH 3



**LEVEL 4  
CABINETS  
KAYES  
WHITE**



**ARIEL  
SILESTONE  
QUARTZ**



**MOEN VOSS  
SINGLE LEVER  
BRUSHED NICKEL**



**SHOWER FLOOR TILE  
CONTESSA ORO 2" X 2"**



**SHOWER WALLS AND BATHROOM  
FLOOR  
CONTESSA ORO MATTE**

Cresswind Twin Lakes | 118 Hartwell Court, Hoschton, GA 30548





## SHOWCASE HOME DESIGNER FEATURES MAIN LEVEL - GENERAL FINISHES

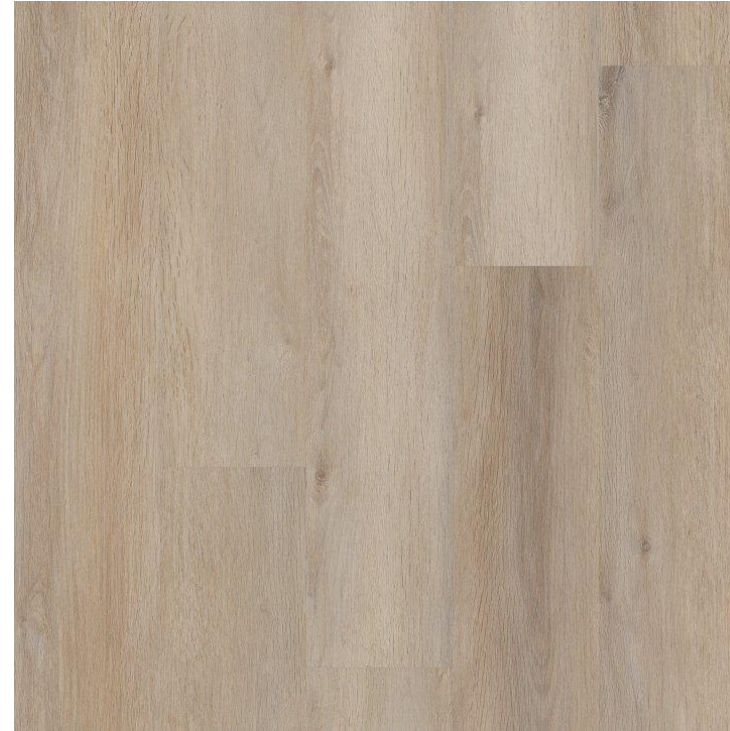
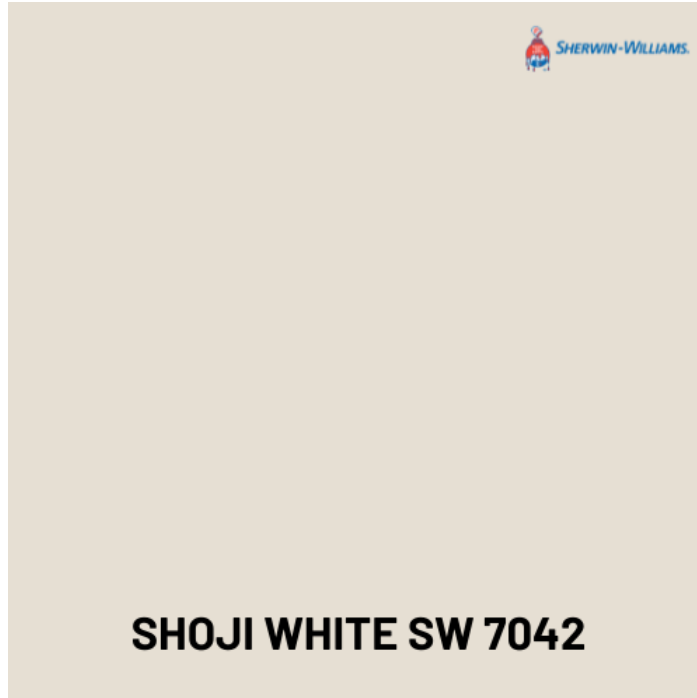

**SHAW EVP FLOORING  
REVERED  
ALDERGROVE OAK**

Cresswind Twin Lakes| 118 Hartwell Court, Hoschton, GA 30548



# SHOWCASE HOME DESIGNER FEATURES | LIGHTING MAIN LEVEL



P4638-09



P4635-09



P3799-09



Cresswind Twin Lakes | 118 Hartwell Court, Hoschton, GA 30548

